

1
2
3
4
5
6
7
8
9
10
11
12
13
14
15
16
17
18
19
20
21
22
23
24
25
26
27
28

MARIPOSA COUNTY RESOLUTION NO. 90-198

A RESOLUTION APPROVING SPECIFIC PLAN AMENDMENT NO. 90-1,
A MAP AMENDMENT TO THE MARIPOSA TPA SPECIFIC PLAN.

COUNTY OF MARIPOSA, APPLICANT.

WHEREAS, an application to amend the Specific Plan for the Mariposa Town Planning Area has been submitted to the County; and

WHEREAS, environmental review has been conducted on the project in accordance with the California Environmental Quality Act and the Mariposa County Environmental Review Policies and Procedures adopted pursuant thereto; and

WHEREAS, the Mariposa County Planning Commission and Board of Supervisors have held duly noticed public hearings on the Specific Plan Amendment in accordance with State Law and County Code.

NOW THEREFORE BE IT RESOLVED that Specific Plan Amendment No. 90-1 resulting in a modification to the Mariposa Town Planning Area Specific Plan Land Use Map, as shown in Exhibit A, is hereby approved by the Mariposa County Board of Supervisors.

BE IT FURTHER RESOLVED that this action of the Board is based upon the findings contained in Mariposa County Planning Commission Resolution No. 90-7 which are hereby incorporated by reference.

BE IT FURTHER RESOLVED that the Mariposa County Board of Supervisors hereby adopts a Negative Declaration for Specific Plan Amendment No. 90-1.

1
2
3
4
5
6
7
8
9
10
11
12
13
14
15
16
17
18
19
20
21
22
23
24
25
26
27
28

PASSED AND ADOPTED by the Mariposa County Board of Supervisors on this 17th day of April, 1990 by the following vote:

AYES: Baggett, Punte, Erickson, Radanovich, Taber
NOES: None
ABSTAINED: None
EXCUSED: None

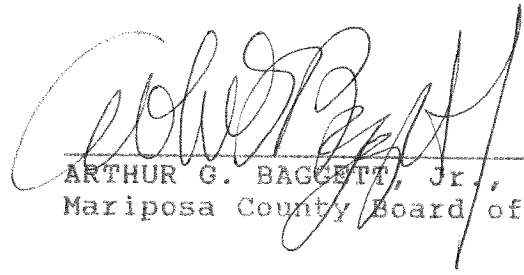

ARTHUR G. BAGGETT, Jr., Chairman
Mariposa County Board of Supervisors

ATTEST:

MARGIE WILLIAMS
Clerk of the Board

APPROVED AS TO FORM AND LEGAL SUFFICIENCY:



JEFFREY G. GREEN
County Counsel

EXHIBIT A

NORTH

10TH ST.

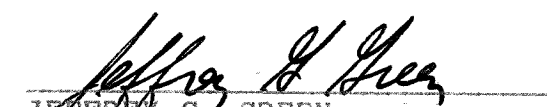
CHARLES ST.

BULLION ST.

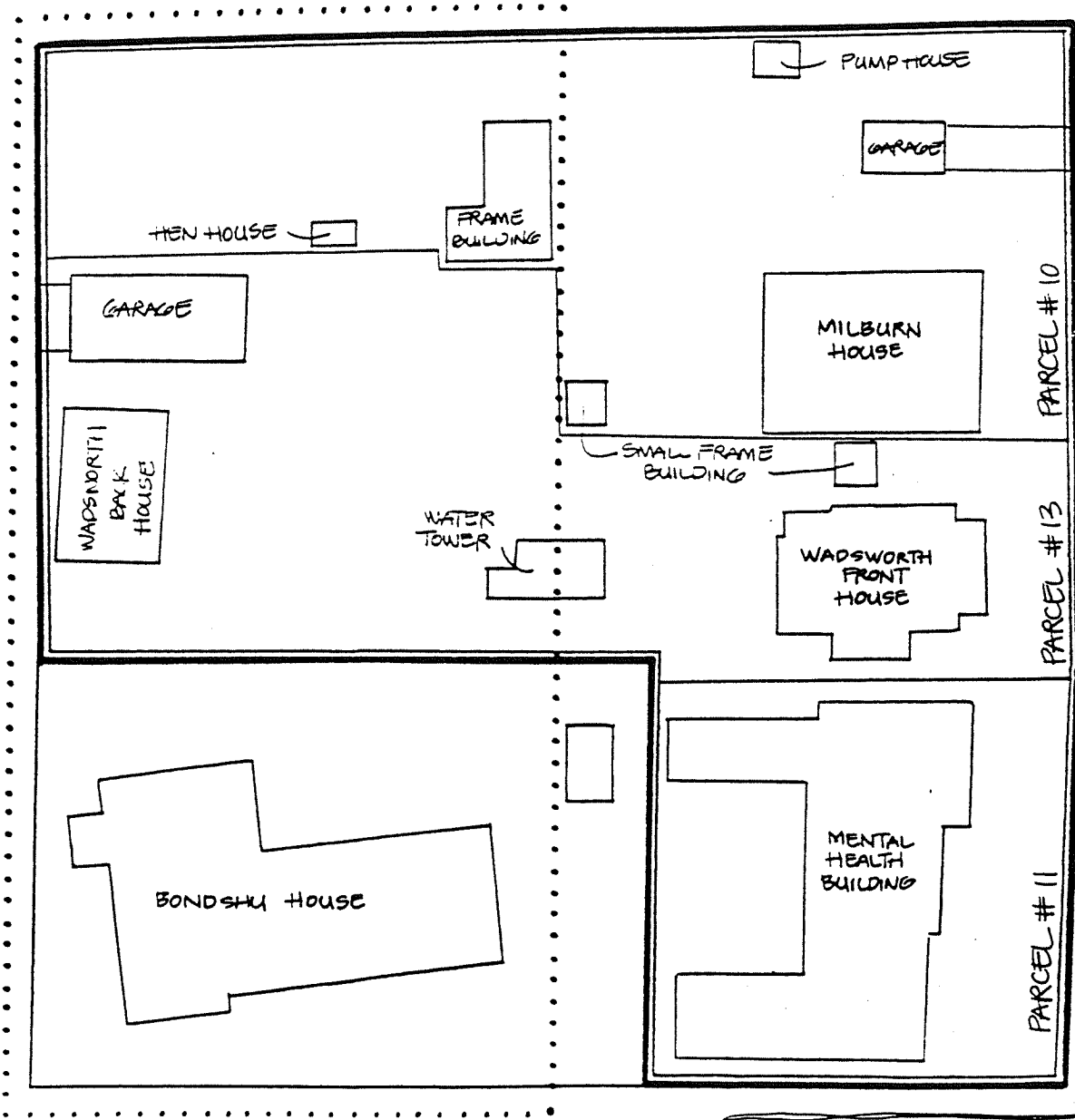

9TH ST.

MAP B

BLOCK # 38

..... AREA WITHIN MULTI-FAMILY RESIDENTIAL LAND USE (REMAINDER OF BLOCK WITHIN PROFESSIONAL OFFICE COMMERCIAL)

==== BOUNDARY FOR COUNTY OWNED PROPERTY - PROPOSED LAND USE DESIGNATION: PUBLIC-QUASI-PUBLIC